

Dramix[®] 3D

45/30BL

Aspect ratio Length Bright Loose

Concrete Reinforcement

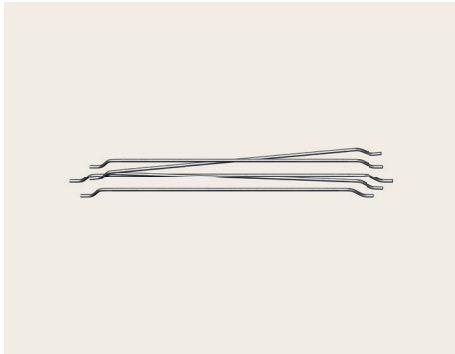

Original anchorage

Dramix[®] 3D is the cost-efficient fiber for standard statically indeterminate concrete structures that are subjected to regular static, fatigue and dynamic loadings.

Material properties

Nom. tensile strength:
184 ksi (1,270 MPa)
 Young's modulus:
30,458 ksi (210,000 MPa)
 Strain at ultimate strength:
0.8 %

Fiber network

6,087 fibers/lb (13,420 fibers/kg)

Geometry

Fiber family



Length (l) * / Diameter

← 1.2 in. (30 mm) →



Aspect ratio (l/d) * : **45**

* Indicative value

Packaging

BAGS:
44 lb (20 kg)

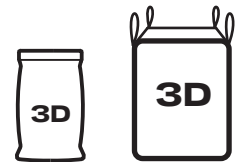

BIG BAG:
1,760 - 2,205 lb (800 - 1,000 kg)

Handling

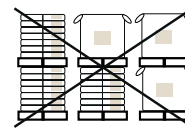

NO STACKING



KEEP DRY

Product certificates*



System certificates*

Dramix[®] plants are ISO 9001 and ISO 14001 certified.



Product conformity

Dramix conforms to:
 ASTM A820-type I,
 EN 14889-1,
 ISO 13270 class A

Contact us:

For inquiries and orders on <https://construction.bekaert.com/contact-us>



For recommendations on stacking, handling, dosing and mixing, visit <https://construction.bekaert.com/dosing>

Any other specific document or certificate can be found on <https://construction.bekaert.com/resources>

* Product and system certificates are plant specific.